

WHITTIER



"Opal Cutting Made Easy"
(Program details on Page 4)



Dig A Little Deeper

What's In A
pen•cil
Besides Wood?



Geography: Create raw materials origin map.

The cedar wood is from the forests in California and Oregon. The graphite (not lead) might come from Montana or Mexico, and is reinforced with clays from Kentucky and Georgia.

The eraser is made from soybean oil, latex from trees in South America, reinforced with pumice from California or New Mexico, and sulfur, calcium, and barium.

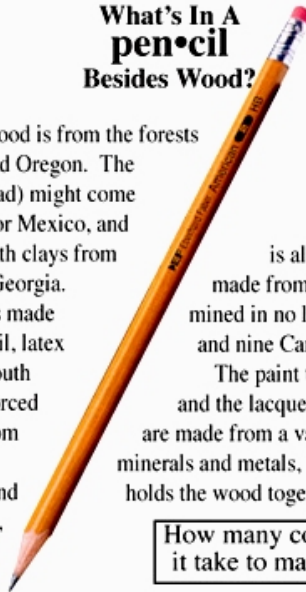

The metal band is aluminum or brass, made from copper and zinc, mined in no less than 13 states and nine Canadian provinces.

The paint to color the wood and the lacquer to make it shine are made from a variety of different minerals and metals, as is the glue that holds the wood together.

How many countries does it take to make a pencil?

Social Studies: Research development of pencil.

For information about minerals in society, contact: Mineral Information Institute at www.mii.org

Math/Science: Count measure, classify, graph classroom pencils.

Writing: Acrostic poem "pencil pal" biography.

ROCKHOUNDER

THE PREZ SEZ:

Well, we made it through our first meeting in our new location. It was a little cramped but cozy. We have been assured we will be in a little bigger room from here on out. **Conrad Grundke** came out again and this time gave a fantastic presentation on intarsia that appeared to be enjoyed by all.

We were also lucky enough to get a little plug on **Channel 6** and it even brought in a guest to our meeting. Not only did we get a guest, we got a new member out of it. This is exactly why I asked everyone to try to bring a friend to at least one meeting this year. We have a wonderful hobby and we can introduce it to new people if we are just willing to share it.

With **President's Weekend** coming up just before our next meeting we have a great opportunity to do some collecting or do some work at home. I would love to see everyone bring in some of their recent work to share with and inspire others. Let's see if we can have a stellar month for our displays at this meeting!

Let's not forget **Valentine's Day** either. Do something special for the one you love. We have one of the greatest hobbies in the world because we can do something we love doing and give it to that special someone. Not only is it something unique, it's something that comes from the heart rather than the pocketbook. I don't know about you, but I always consider that kind of gift much more special.

If you do go out collecting, please remember safety first. I hope to see plenty of familiar faces, and some not so familiar, at the next meeting.

James

**WGMS General Meeting
February 26 at 7:30 PM**

NEW LOCATION!!!

Whittier Community Center
7630 Washington Ave. Whittier
(see map on page 15)

PROGRAM:

Video: "Opal Cutting Made Easy"

For February, we will feature a excellent video tutorial on Opal Cutting. Rough opal is available at many gem shows and can be a very rewarding stone to cut. It can also frustrate you to no end . Hopefully, this video will clear up some of the mystery and angst associated with the art of opal cutting and polishing.

Izzie B., 1st VP.

News from Around the Club...

Les & Bea Roy are both recovering from a severe bout with this year's incarnation of the flu bug. Les is doing good but Bea is still having a rough time.

The first general meeting at the **Whittier Community Center** was a qualified success. Our speaker, **Connie Grundke**, presented an excellent program under, shall we say, cozy conditions. The room was designed for 15 people, we had 21. Even so, a good time was had by all. At this meeting, we accepted the application for membership of **Vivian & Larry Rice**, of **Whittier**. **Vivian** knew about us but didn't know when or where we met. She found that information on **Channel 6**, the local TV access channel. **Kathy & Jerry Turner** can take the credit for putting out the word to the local Whittier outlets. **Thanks guys, good job!**

I want to say a hearty WELCOME to 3 new members. At the **February Board Meeting**, we accepted the membership applications of **Vivian & Lar-**

News from Around the Club...(Continued)

ry Rice and Susan Lomeli of Phillips Ranch. Susan came to our 2003 Gem Show but only turned her application recently to Joe Goetz.

How many of you remember that we have a **Club library**? For the last couple of years, it has been at Sorenson Park, buried in a back closet and basically unavailable. It has been removed from Sorenson Park and is on its way to the **Turner's** house for inventory. Hopefully, it will become available to members once again in the very near future. Along those same lines, **if you have any WGMS Club books at home, please return them at the next meeting** so we can inventory them. We are particularly interested in the fine **petrified wood identification book** which the Club purchased a couple of years ago. No late fees will be levied, so **if you got 'em, bring 'em.**

We have several work days coming up in the near future. The Club equipment at the **Boys & Girls Club** has to be removed to storage and this is going to happen **Friday, February 20th at 4:30 PM.** On **March 1st,** we will be moving the rest of the rocks from **Mary Rose Merten's** house to **Joe & Marcia Goetz'** back yard for sorting and slabbing. Finally, we are going to meet on a **weekend in March (to be announced)** to set up shelving at **Art & Ginger Ragazzi's** warehouse and organize our stored show cases and other items. In case I didn't mention it before, we have removed our show cases and other gear from **Hans Lind's garage** and moved to it all to **Art & Ginger's house** as a temporary solution to our cash flow problems. We are still seeking a **trailer** as a long term solution to our storage problems but for now, **Art & Ginger** are helping us out.

And speaking of **Mary Rose Merten,** **Mary Rose** has graciously donated her Graves Faceting Machine to the WGMS for use at the Rockgabbers meetings as a teaching tool for faceting. **Thank you very much, Mary Rose!**

We have a Show Date and Theme!

There was some discussion this year about changing the date of our annual gem show from its usual **3rd weekend in October** to some other date due to conflicts with major league baseball and other gem club shows. Your **WGMS Board** has decided to stick with our regular weekend which will be **October 16 & 17, 2004.** The show theme for the 2004 Gem Show will be, **"HOW DO YOU DO..."**, as in, "How do you do...wire-wrap," or "How do you do...gemstone carving". Show flyers should be available by the February 26 regular meeting for distribution to other shows, family and friends.

JValle

Pipestone Voices

Dr. Bill Cordua, University of Wisconsin- River Falls

Pipestone, sometime called "catlinite" is a soft red to mottled fine-grained material that carves well. Native Americans use this material extensively in ceremonial pipes and other objects. The material itself, as well as the sites in which it is found, have great religious significance to them.

Early last summer I visited Pipestone National Monument in southwestern Minnesota. In one of the quarries, an elderly Native American was working with hammer and chisel on the hard quartzite that overlies the valuable pipestone. His grandson was watching him. I asked the grandson if he would allow a photograph. His grandson said no, and that I shouldn't stand and watch for long either. His grandfather would stop working and wait until I was gone. Strangers affected his meditation with the rock. His grandson said. "The rocks talk to him. He will study the rock and it will tell him which piece to move next. He may work for half an hour on a small rock, then be able to move many large pieces of rock rapidly."

I left thinking that I had had similar experiences, studying a rock with a fine fossil or beautiful crystals and having a sudden inspiration as to how to work the rock to retrieve the specimen. I've also struck a rock knowing that it was the absolute wrong thing to do, and having the specimen shatter to worthless fragments before my eyes. To what extent the mystical enters into this is up to each to judge on his or her own.

Pipestone also "talks" to geologists in more prosaic ways. Its mineral content and occurrence allow us to piece together a detailed picture of its formation. At Pipestone, Minnesota, it is part of the a formation called the Sioux Quartzite. The Sioux Quartzite was deposited about 1.6 billion years ago by a series of braided rivers, flowing across wide floodplains. The environment is not unlike that of the Red River Valley today. Most of the time the rivers deposited sand and gravel. After flooding, however, the rivers left deposits of clay on the floodplain as the waters receded. Most of the time, this material was rapidly eroded away. But some times, patchy deposits of this were buried under sand and preserved. The entire package of sand, gravel and clay was buried and metamorphosed. The sand and gravel formed quartzite and the clay and silt lenses formed the pipestone.

Pipestone consists of a fine-grained intergrowth of sericite, kaolinite,

diaspor, hematite and pyrophyllite. Quartz grains are also present, but the more quartz, the harder the pipestone is to carve. Sericite is a fine-grained mica. Kaolinite is an aluminium-rich clay mineral. Diaspor is an aluminum hydroxide. Pyrophyllite is an aluminum silicate. These minerals tend to be very soft. The minerals forming pipestone did not all form at the same time. The sediment originally likely contained mostly clay minerals, plus quartz and feldspar. The metamorphism caused the feldspar to decompose and the clay minerals to form the pyrophyllite and sericite. Later weathering and interaction with ground water formed the kaolinite and diaspor from the sericite and pyrophyllite. It is this mix of minerals that results in the pipestone color, carvability and other desirable properties.

Pipestone is indeed a unique material. Its beauty and the beauty of the items carved from it speak to us all.

References:

- Morey, G. B., 1983, *Evaluation of the Catlinite Resource, Pipestone National Monument*, U.S. National Park Service, Resource Management Report MWR-4, 48 p.
- Murray, Robert A., 1968, *Pipes on the Plains*, Pipestone Indian Shrine Association, 41 pp.

Breccia, 12/03

DUES ARE DUE

It is DUES time again and the WGMS needs you. Your continued support allows us to produce this newsletter and helps provide the meeting location. Thanks to all of you who have already sent in your check.

The membership breakdown has not changed and is as follows:

Single adult	\$15.00
Married Couple	\$25.00
Junior Member	\$5.00

Please send your dues to the Treasurer, Jay Valle at:

Jay Valle
1421 Latchford Avenue
Hacienda Heights, CA 91734

Field Trips

The fieldtrip for February is going to be to the **Oceanview Tourmaline Mine in Pala**. The date is **February 22nd**, which is a Sunday. If we get 26 people to sign up to go the cost will be \$40 per person, if we get 25 or less to sign up and show up the cost will be \$50 per person. The operation at the Oceanview is different than the Stewart or the Himalayan mines, i.e. they have a large flat area where they bring a skip loader load from the **Elisabeth Mine** and from the **Oceanview** and that is what you dig and sift through. You keep all you find. They even suggest you bring a wagon to take your rocks home! If you want a tour of the mine they give you a fifteen minute underground safety lesson and provide you with a hard hat and steel toed shoes. The area where we'll be has a barbeque/ picnic area and flush toilets. The website is www.digforgems.com. I'll be talking to them shortly for additional information. We'll have to sign liability forms, and I'll have to get the e-form from them. **Please contact me if you plan to go**. Either call me at **(626) 914-5030** and or e-mail at joenmarl@gte.net. It should be a fun day and with 20 to 28 people will allow us to have the place to ourselves.

For Presidents' weekend we will be going to the **Southern Pacific Silica Quarry on Saturday, February 14th**. On **Sunday or Monday** we'll perhaps do a day trip of exploration to a site yet to be determined. Let me know if you are going to go to the quarry and I'll send you a map via e-mail or we'll meet somewhere along the way, then go there. For those of you who have a GPS unit **the co-ordinates are** (Thanks to **Jay Valle**) 33° 47.154 N by 117° 07.626 W. There are two schools of thought as to what actually was mined. One school is it was for the feldspar for ceramics, and the other is it was mined for the tabular quartz crystals for making lens or radio crystals during WWII. Well, even though the reason is lost to history, there are lots of things to find. There is the optically clear quartz, rose and smoky quartz (all tabular), some of it asteriated (star producing), as well as feldspar which may produce moonstone, garnets (iron and orange), beryl and shorl. We found everything except the beryl. The collecting isn't bad, if doing so from the dumps, but it is hard rock mining if you want to extract the black tourmaline from the feldspar itself. We had fun and so could you.

Bewildered somewhere in California
Joe Goetz

A FIELD TRIP IS A SOCIAL OCCASION



--Cartoon by Erston Barnhart in *Are We Having Fun Yet? An Irreverent but Affectionate Look at Rockhounds*

Courtesy of Tooele Gem & Mineral Society via Golden Spike News 11/01

2004 Fieldtrip schedule

- Feb. 14-16 Local day trips: See article on facing page.
- Feb. 22 Oceanview Mine. Contact Joe if you want to go.
See article on facing page.
- March 20-21.....Lavic Siding
- March 22-26.....Extended trip with Vern & Sylvia to Burro Creek
- March 27-28.....The Cottonwood, Arizona Show
- April (to be announced)..Local day trips
- May 29-31Broadwell Dry Lake
- Jun through Aug.No trips
- Sept. 25-26Paul Bunyon
- Oct. 23-24Whittier Club Claim
- Nov. 25-28Death Valley area not in Death Valley.

Useful Trivia
contributed by Shirley Leeson

Did You Know?

1. Drinking two glasses of Gatorade can relieve headache pain almost immediately - without the unpleasant side effects caused by traditional pain relievers.
2. Did you know that Colgate toothpaste makes an excellent salve for burns.
3. Before you head to the drugstore for a high-priced inhaler filled with mysterious chemicals, try chewing on a couple of curiously strong Altoids peppermints. They'll clear up your stuffed nose.
4. Achy muscles from a bout of the flu? Mix 1 Tablespoon of horseradish in 1/2 cup of olive oil. Let the mixture sit for 30 minutes, then apply it as a massage oil, for instant relief for aching muscles.
5. Sore Throat?? Just mix 1/4 cup of vinegar with 1/4 cup of honey and take 1 tablespoon six times a day. The vinegar kills the bacteria.
6. Cure urinary tract infections with Alka-Seltzer. Just dissolve two tablets in a glass of water and drink it at the onset of the symptoms. Alka-Seltzer begins eliminating urinary tract infections almost instantly - even though the product was never been advertised for this use.
7. Eliminate puffiness under your eyes. All you need is a dab of Preparation H, carefully rubbed into the skin, avoiding the eyes. The hemorrhoid ointment acts as a vasoconstrictor, relieving the swelling instantly.
8. Honey remedy for skin blemishes. Cover the blemish with a dab of honey and place a band-aid over it. Honey kills the bacteria, keeps the skin sterile, and speeds healing. Works overnight.
9. Listerine therapy for toenail fungus, get rid of unsightly toenail fungus by soaking your toes in Listerine mouthwash. The powerful antiseptic leaves your toenails looking healthy again.
10. Easy eyeglass protection. To prevent the screws in eyeglasses from loosening, apply a small drop of Maybelline Crystal Clear nail polish to the threads of the screws before tightening them.
11. Coca-Cola cure for rust. Forget those expensive rust removers. Just

saturate an abrasive sponge with Coca Cola and scrub the rust stain. The phosphoric acid in the coke is what gets the job done.

12. Cleaning liquid that doubles as bug killer. If menacing bees, wasps, hornets, or yellow jackets get in your home and you can't find the insecticide, try a spray of Formula 409. Insects drop to the ground instantly.
13. Smart splinter remover. Just pour a drop of Elmers Glue all over the splinter, let dry, and peel the dried glue off the skin. The splinter sticks to the dried glue.
14. Hunt's tomato paste boil cure. Cover the boil with Hunt's tomato paste as a compress. The acids from the tomatoes soothe the pain and bring the boil to a head.
15. Balm for broken blisters. To disinfect a broken blister, dab on a few drops of Listerine.... a powerful antiseptic.
16. Heinz vinegar to heal bruises. Soak a cotton ball in white vinegar and apply it to the bruise for 1 hour. The vinegar reduces the blueness and speeds up the healing process.
17. Kills fleas instantly. Dawn dishwashing liquid does the trick. Add a few drops to your dog's bath and shampoo the animal thoroughly. Rinse well to avoid skin irritations. Goodbye fleas.
18. Rainy day cure for dog odor. Next time your dog comes in from the rain, simply wipe down the animal with Bounce or any dryer sheet, instantly making your dog smell springtime fresh.
19. Eliminate ear mites. All it takes is a few drops of Wesson corn oil in your cat's ear. Massage it in, then clean with a cotton ball. Repeat daily for 3 days. The oil soothes the cat's skin, smothers the mites, and accelerates healing.
20. Vaseline cure for hairballs. To prevent troublesome hairballs, apply a dollop of Vaseline petroleum jelly to your cat's nose. The cat will lick off the jelly, lubricating any hair in its stomach so it can pass easily through the digestive system.
21. Quaker Oats for fast pain relief. It's not just for breakfast anymore! Mix 2 cups of Quaker Oats and 1 cup of water in a bowl and warm in the microwave for 1 minute, cool slightly, and apply the mixture to your hands for soothing relief from arthritis pain.

AFMS Newsletter 10/03 via Rockhound Rambling 12/03

Some Thoughts to Ponder

Ever Wonder?

- Why the sun lightens our hair but darkens our skin?
- Why women can't put on mascara with their mouth closed?
- Why we don't see the headline "Psychic Wins Lottery"?
- Why "abbreviated" is such a long word?
- Why is it that doctors call what they do "practice"?
- Why is it that to stop Windows 95/98 on your computer, you have to click on "Start"?
- Why is lemon juice made with artificial flavor, and dish washing liquid is made with real lemons?
- Why is the man who invests all your money called a "broker"?
- Why is the time with the slowest traffic called "rush hour"?
- Why isn't there a mouse flavored cat food?
- When dog food is new and improved tasting, who tests it?
- Why didn't Noah swat those two mosquitoes?
- Why do they sterilize the needle for fatal injections?
- You know that indestructible black box that is used on airplanes? Why don't they make the whole plane out of that stuff?
- Why don't sheep shrink when it rains?
- Why are they called apartments when they are all stuck together?
- If con is the opposite of pro, is Congress the opposite of progress?
- If flying is so safe, why do they call the airport a terminal?

From Athertonian, by Howard Stewart, via Del Air Bulletin 3-03, via Rockhound Rambling 11/03

Upcoming CFMS Gem Shows

- Feb 13-22** **Indio, CA.** San Gorgonio Mineral & Gem Society
"Riverside County Fair & National Date Festival"
Gem & Mineral Bldg. Fairgrounds; 46-350 Arabia St.
Hours: 10 - 10
- Feb 27-** **Imperial, CA.** Imperial Valley Gem & Mineral Society
Mar 7 Imperial Valley Fairgrounds
Hours: week days 12-10; Weekends open later
- Mar 6-7** **Arcadia, CA.** Monrovia Rockhounds, Los Angeles County
Botanical Gardens, 301 N. Baldwin Avenue
Hours: 9-4:30 both days
- Mar 6-7** **Ventura, CA.** Ventura Gem & Mineral Society
Seaside Park - Ventura Co. Fairgrounds
10 W. Harbor Blvd. Hours: Sat 10-5 Sun 10-4
- Mar 13-14** **San Marino, CA. Pasadena Lapidary Society**
San Marino Masonic Center, 3130 Huntington Dr.
Hours: Sat. 10 - 6; Sun. 10 - 5
- Mar 20-21** **San Diego, CA.** San Diego Mineral & Gem Society
Al Bahr Shrine Center, 5440 Kearny Mesa Road
Hours: Sat. 9:30-5; Sun. 10-4
- Apr 3-4** **Torrance, CA.** South Bay Lap & Mineral Society
Torrance Recreational Center, 3341 Torrance Blvd.
Hours: 10-5 both days
- Apr 24-25** **Hacienda Heights, CA.** Puente Hills Gem & Mineral Club
Steinmetz County Park, 1545 S. Stimson Ave.
Hours: 10 - 5 both days
- Apr 24-25** **Lancaster, CA.** Antelope Valley Gem & Mineral Club
Antelope Valley Fairgrounds, 2551 W. Avenue H
Hours: 9 - 5 both days
- May 1-2** **Anaheim, CA.** Searchers Gem & Mineral Society
Brookhurst Community Center, 2271 W. Crescent Ave.
Hours: Sat 10 - 5 Sun. 10 - 4:30

**MINING AND PROSPECTING EQUIPMENT
 DREDGES & GOLD PANNING EQUIPMENT
 GOLD & METAL DETECTORS – GPS UNITS
 ROCKHOUND TOOLS AND SUPPLIES
 BOOKS & MAPS – CALIFORNIA & USA**

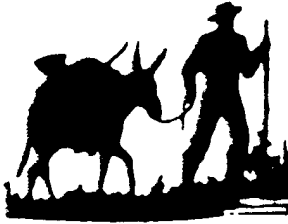

**CAL-GOLD
 ENTERPRIZES
 10 – 6 M-F — 10 – 4 SAT**

**2569 E. COLORADO BLVD.
 PASADENA, CALIFORNIA 91107-3745
 Email: calgold@earthlink.net**

**(626) 792-6161
 FAX (626) 792-1226
 Web site: www.calgold.net**

SporTrak™ Pro



NEW!

MAGELLAN

The Ultimate In Lightweight GPS

- 9 MB North American basemap of roads, waterways, parks airports...
- 23 MB of built-in memory for additional detailed map downloads
- Large LCD Display
- Rugged, waterproof & lightweight (6.1 oz)
- 3 meter accuracy via WAAS

MAGELLAN

Thales Navigation
 960 Overland Court, San Dimas, CA 91773
 Tel: 909-394-5000 ● Fax: 909-394-7070
www.magellangps.com

© 2002 Thales Navigation, Inc. All rights reserved. Magellan is a registered trademark of Thales Navigation. SporTrak is a trademark of Thales Navigation.

NEW MEETING LOCATION!
Whittier Community Center
7630 Washington Ave. Whittier

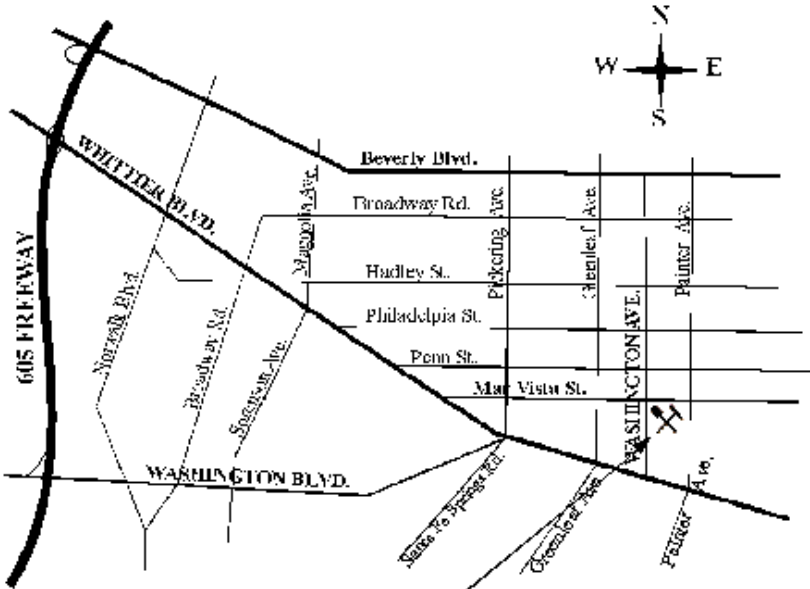

MAR VISTA & WASHINGTON AVE.  WHITTIER COMMUNITY CENTER

Editor: Jay Valle, 1421 Latchford Avenue, Hacienda Heights, CA 91745
 Home: (626) 934-9764; E-Mail: jvalle@aqmd.gov
Bulletin exchanges are welcome and should be sent to the editor.

Affiliations



California Federation of Mineralogical Societies
 American Federation of Mineralogical Societies
 Special Congress Representing Involved Bulletin Editors



Whittier Gem and Mineral Society, Inc.
Post Office Box 865, Whittier, California 90608-0865
Editor: Jay Valle, 1421 Latchford Ave.
Hacienda Heights, CA 91745

Meeting Date: February 26, 2004 at 7:30 PM
Location: Whittier Community Center
(see page 15 for map)